

The diagram shows how to construct the front motor mount for 1936 Series 60, 70, 75 Cadillacs. This mount is used only on these cars and no others.

The lower part of the mount is constructed using 1 1/2 inch X 1/8 inch thick angle iron. One side is cut to the 3/8 dimension. The top part is made by bending 1/8 inch plate steel. Two 7/16X20 nuts are welded to the bottom side of the bottom bracket, and the neoprene pad is glued in place using the indicated glue.

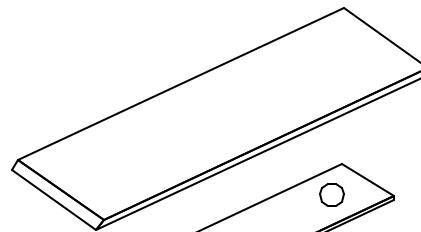
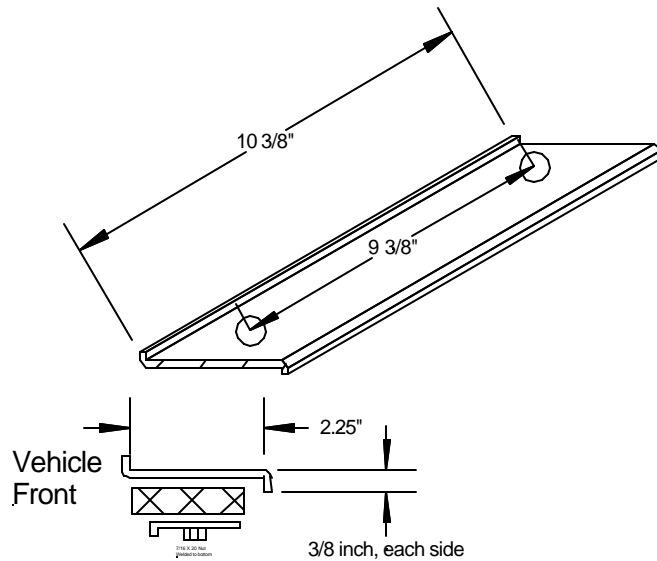

2" X 6" X 1/2 inch
Neoprene
Glue Neoprene to Metal
Using StaBond Neoprene/Sponge
Adhesive # 835/6

For assembly, it is best to affix the pad to the upper mount only, then, with the cement already applied to both the lower bracket and the bottom of the neoprene, attach the upper mount

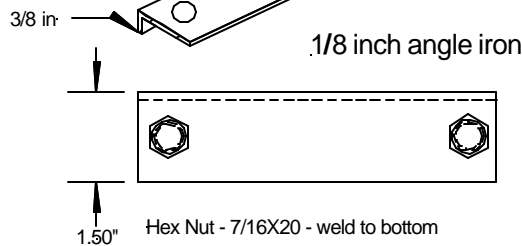

1936 Cadillac Front Motor
Mount Assembly
Cadillac Part # 141866
Fits series 60, 70, 75 only

to the engine and the lower mount to the frame. Then lower the engine to press the neoprene pad onto the mount with the proper alignment.

Note that the assembly to the frame requires washers beneath the nuts (between the nuts and the frame) and uses a metal strap (make this from the scrap cut off of the angle iron) with two matching holes below the frame. Bolt length for the lower bracket is 3/4 inch and is critical, a longer bolt will penetrate into the pad.